

*J. Higgins*



## **MODEL 51**

**DELUXE BIG-GAME RIFLE**

**.30-06, or .270 Caliber**

*Available with 2½-, 4-, or 6-Power 'Scope*

# MODEL 51

The J. C. Higgins Model 51 is a 5-shot deluxe grade high-power big-game rifle that costs much less than any other rifle of comparable quality. Your choice of America's favorite big-game cartridges — .270 or .30-06 — is available in the Model 51.

Its genuine Fabrique Nationale Mauser sporting action is world-renowned for strength, simplicity and ease of operation. Trigger is smooth and creep-free. Barrel is fine proof-tested molybdenum steel with chromed bore, built to take a lifetime of normal use.

Stock is beautifully grained checkered American walnut with high-combed cheekpiece, full pistol grip and semi-beavertail forearm. Receiver is drilled and tapped to take standard Weaver telescope mounts and bases, as well as any of the well-known receiver sights (see Fig. 1 for receiver sight installation instructions).

Three fine telescopic sights in your choice of 2½, 4 or 6 power have been custom designed for this super-accurate hunting rifle. When one of these scopes is purchased with Model 51, mount and installation are provided without extra charge.

Sling is genuine leather.

## CLEANING & LUBRICATING

**IMPORTANT:** Before firing this gun, be sure to thoroughly clean inside of barrel of all grease and any obstructions.

After making sure the rifle is empty, remove the bolt by putting the safety in the off position, raising the bolt handle and pulling the bolt straight back to the rear, and then, pulling out the thumb piece at the left rear of the receiver as far as it will go to remove the bolt the rest of the way.

Push a brass cleaning brush soaked in nitro solvent through the barrel from the rear chamber end and work it through the entire length of the bore several times. Follow this by pushing clean patches through the bore until the last patch comes out unsoiled. A light protective film of oil may be applied to the clean bore. Periodically, dirt and fouling should be removed from the bolt and other operating parts, also. This should be done with a tooth brush soaked in nitro solvent, followed by a thorough wiping and light oiling.

Your Model 51 is treated with new siliconized and polarized oil. This exclusive patented process gets down into the pores of the steel and protects against perspiration and other corrosive elements which cause rust. This oil makes J. C. Higgins guns the most rust resistant of any guns you can buy. It gives the best lubrication of any oil tested. And it protects and beautifies stock and forearm.

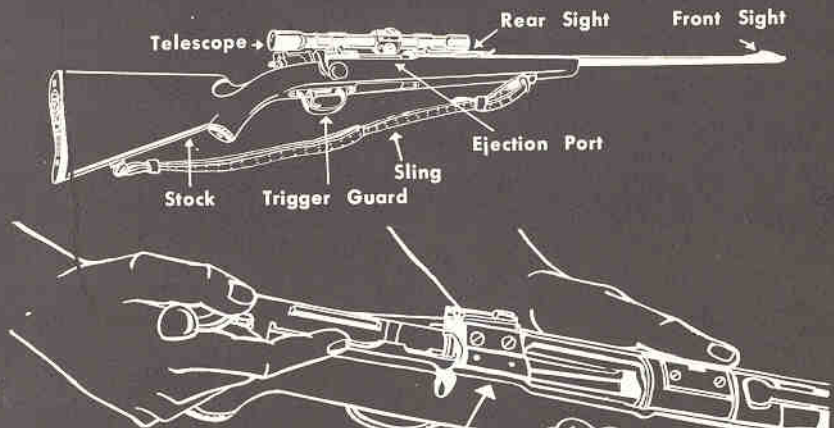
A J. C. Higgins Rifle Cleaning Kit is available in either .270 or .30-06 caliber (at any Sears' Store or from the catalogue), which includes all the necessary materials to carry out the above operations. Another valuable piece of equipment is a J. C. Higgins Silicone Cloth which will help by protecting the outside surfaces of the rifle from rust and moisture.

## OPERATING INSTRUCTIONS

**TO REPLACE BOLT:** Align bolt as shown in Fig. 1 with mating surfaces on bolt in line with mating surfaces on receiver. Push bolt forward against tension of thumb piece on receiver. See Fig. 2. If the bolt does not slide into the rifle, check alignment of extractor. Extractor should be aligned with lugs at front and rear of bolt. Fig. 6 shows extractor out of alignment with lugs. Fig. 7 shows correct alignment of extractor.

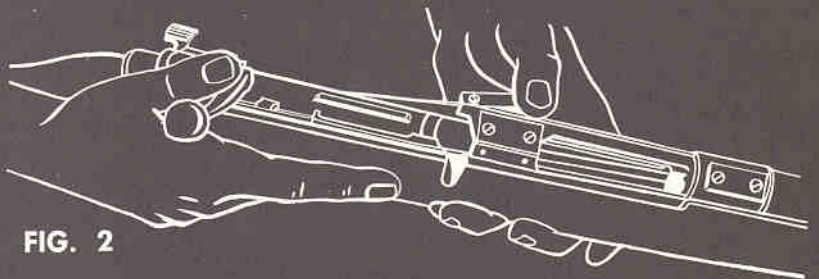
**TO MAKE GUN SAFE:** Safety is located at rear of bolt. The action is locked when safety lever is in raised position. See Fig. 3. Safety is off when lever is in horizontal position (to the left). See Fig. 4. Safety can be applied only when action is cocked. Always use safe when carrying a loaded gun.

**TO RELEASE SAFETY:** Push safety to left and down (horizontal position) and gun is ready to fire.

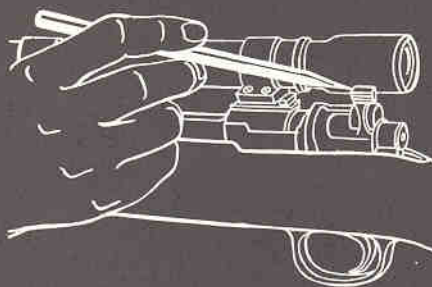


**FIG. 1**

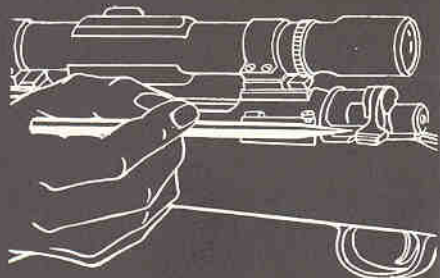
Receiver is drilled and tapped here for installation of receiver sight. To install, remove a small portion of the wood as required to fit the sight correctly.



**FIG. 2**



**FIG. 3**



**FIG. 4**

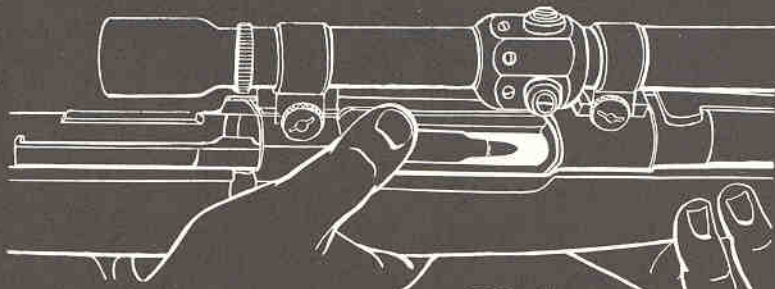


FIG. 5

LOCKING LUG EXPOSED

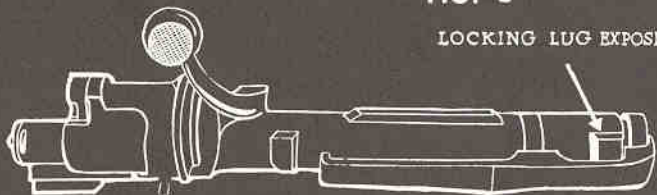


FIG. 6

LOCKING LUG CONCEALED

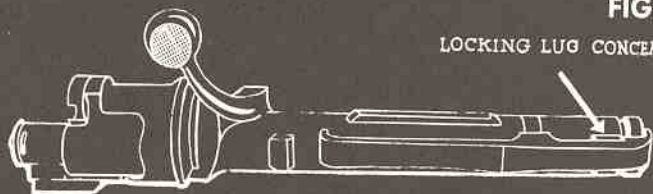


FIG. 7

## S P E C I F I C A T I O N S

CALIBER	<u>270</u>	<u>.30/06</u>
WEIGHT (LBS)	7 1/2	7 1/2
LENGTH OF PULL (INCHES)	13 1/2	13 1/2
DROP AT COMB (INCHES)	1 11/16	1 11/16
DROP AT HEEL (INCHES)	2 3/8	2 3/8
BARREL LENGTH (INCHES)	22	22
RIFLING	4 Grooves, Right Hand Twist, 1 Turn in 10 Inches	
BOLT	Heat-treated, hardened	
OVERALL LENGTH (INCHES)	42 3/4	
BARREL	Chromium-Molybdenum Steel, Chromed bore	
SIGHT, FRONT	Patridge, gold bead, with ramp	
SIGHT, REAR	Patridge with elevator for changes in elevation each notch changing the point of impact 1" at 100 yards.	
STOCK & FORE-END	Genuine American Black Walnut	

**TO LOAD CHAMBER:** Raise the bolt handle as far up as it will go and draw straight back to rear as far as possible. The cartridge is then placed in the magazine. The rifle should not be loaded by dropping the cartridge directly into the chamber. The cartridge is placed as far back over the magazine as it will go and pushed down into the magazine where it is caught and held by edge of receiver. See Fig. 5. Pushing the bolt forward will load the chamber and gun will be ready to fire.

**TO LOAD THE MAGAZINE:** Follow the same procedure as in loading the chamber, loading up to the magazine capacity of five cartridges before closing the bolt. Cartridges are held in staggered column.

**TO OPERATE:** When gun is fired raise the bolt handle and pull back sharply to the rear as far as it will go. Push the bolt forward and the bolt handle down to load the gun with a cartridge from the magazine. Always use the safety to prevent accidental firing.

**TO REMOVE LOADED SHELL FROM CHAMBER WITHOUT FIRING:** With safety in off (horizontal) position, raise the bolt handle and pull the bolt back sharply. This will extract and eject the unfired cartridge. Hold the left hand over the loading port to catch the unfired cartridge.

**TO REMOVE LOADED SHELLS FROM MAGAZINE:** Push down cartridges in magazine with the fingers and push bolt forward, making sure no cartridge has been fed into chamber, and lock by turning down the bolt handle. Turn gun so that trigger guard is up. Press catch button inward at rear end of floor plate and slide plate slightly to the rear. This will release floor plate and allow it to come out. The cartridges will then drop out into the hand when the gun is turned over.

**TO REPLACE THE FLOOR PLATE:** Insert the magazine follower and spring into the magazine opening, with the hole in the floor plate toward the rear. Engage the front end first and then the rear end over the catch button. Then slide forward until plate clicks to lock. Make sure the magazine follower is properly centered in the magazine.

**TO REMOVE STOCK FROM ACTION:** Remove bolt. Turn gun with trigger guard up. Remove floor plate and magazine follower. Remove two screws holding trigger guard to action. Lift stock away from action. Trigger guard may then be removed by grasping trigger guard and pulling out.

**TO REPLACE THE ACTION IN THE STOCK:** Insert the trigger guard in the stock with the floor plate assembly removed (floor plate, follower and spring). Then replace the action and barrel in the stock. Put in the two screws and tighten. Short screw goes in front. After making sure these screws are tight, replace floor plate and bolt.

## **SIGHTING IN**

This rifle is sighted in at the factory for zero alignment at 100 yards with open sights and with telescopic sights when purchased with the rifle. However, since methods of holding and sighting differ for each individual, no one can perfectly adjust the sights for another. For this reason, it is recommended that the individual shooter check his own sight adjustment. If the rifle is to be used with open sights only, remove the scope blocks and install the four dummy screws flush with the top of receiver.

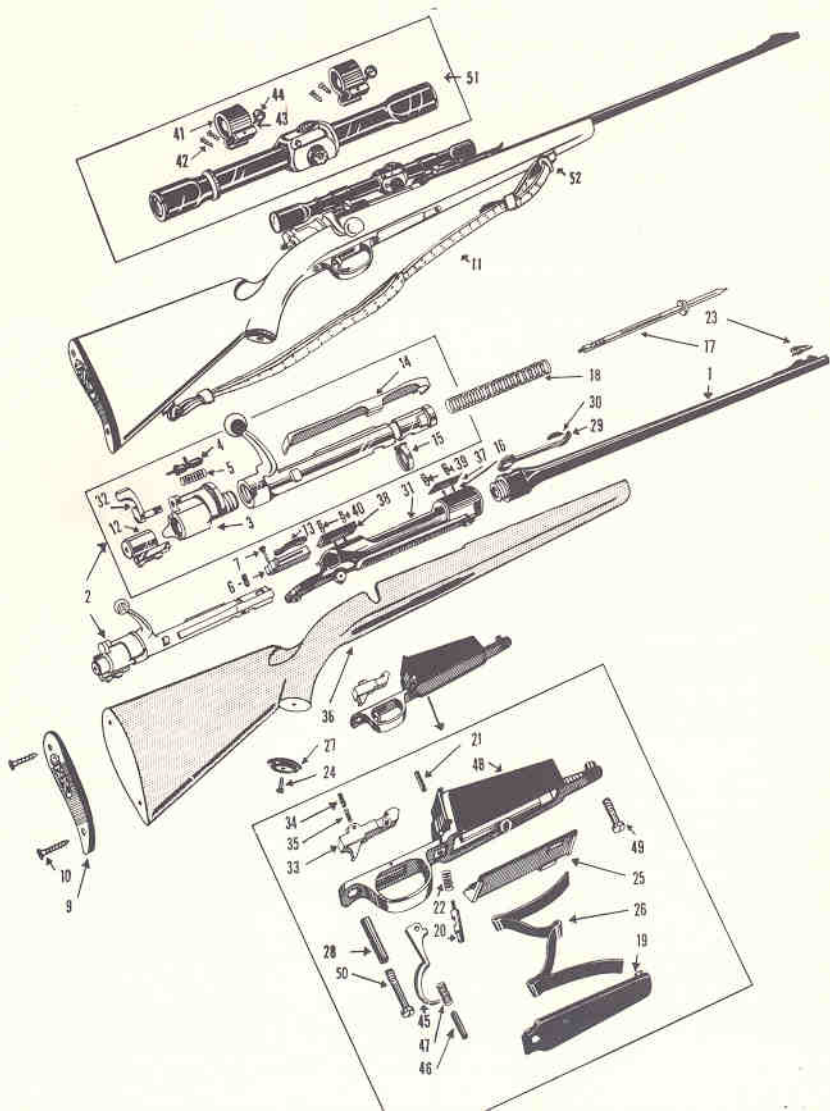
**ADJUSTING OPEN SIGHTS:** If a rifle rest is available, shoot from a sitting position with the forearm of the gun (not the barrel) resting on a yielding surface (rubber or cloth pad). If no rest is handy, lie prone and use a rolled up blanket beneath the forearm as a rest. Set up the target at whatever range your requirements indicate. Fire a three to five shot group. If the center of the group is not centered on the target, move the rear sight in the direction you want the group to go. (To raise the point of impact, elevate the rear sight; to move group to the left, tap rear sight to the left with a brass or plastic hammer).

**ADJUSTING TELESCOPIC SIGHTS:** Assemble the scopes rigidly to gun and use a rest as outlined in Open Sight instructions. Set up a target at desired range and adjust according to instructions enclosed in the scope package. Sight in with the same type ammunition that you intend to use while hunting, especially if you anticipate shots at extreme ranges.

# List of Parts and Assemblies

J. C. HIGGINS MODEL 51 Model Nos. 583.99 (.270 Cal.) and 583.100 (.30-06 Cal.). One of these numbers is marked on the barrel. Be sure to mention it when ordering.

HOW TO ORDER — Specify Model No., Reference No., Part No. and Part Name. Parts marked with an asterisk (\*) must be fitted by gunsmiths in Sears mail order houses, or by outside gunsmiths.



WHERE TO ORDER REPAIR PARTS — Any Sears  
retail or mail order store will handle your  
order.

REF. NO.	PART NO.	PART NAME	REF. NO.	PART NO.	PART NAME
1	590-MA	*Barrel Assembly, Cal. .270 Win.	53	598	Sling Swivel, Front
1	591-MA	*Barrel Assembly, Cal. .30/06	36	593M	Stock Assembly Composed of:
2	570M	*Bolt Assembly		593	Stock
3	411	Bolt Sleeve		620	Butt Plate
4	11A	Bolt Sleeve Lock Plunger		562	Butt Plate Screw
5	56	Bolt Sleeve Lock Plunger Spring	51	560-M	Telescope Assembly, 2.5X Composed of:
6	17	Bolt Stop		560	Telescope, 2.5X
7	43	Bolt Stop Screw		547-1	Telescope Clamp Rings (2)
8	18	Bolt Stop Spring		552	Telescope Clamp Ring Screws (4)
9	620	Butt Plate		550	Telescope Mount Ring Clamp Screws (2)
10	562	Butt Plate Screw		551	Telescope Mount Ring Clamp Screw Nuts (2)
11	701	Carrying Sling, 1"	51	592-M	Telescope Assembly, 4X Composed of:
12	414	*Cocking Piece		592	Telescope, 4X
13	19	Ejector		547-1	Telescope Clamp Ring (2)
14	15	Extractor		552	Telescope Clamp Ring Screws (4)
15	16	Extractor Collar		550	Telescope Mount Ring Clamp Screws (2)
16	568	Filler Screw		551	Telescope Mount Ring Clamp Screw Nuts (2)
17	13	Firing Pin	51	596-M	Telescope Assembly, 6X Composed of:
18	57	Firing Pin Spring		596	Telescope, 6X
19	23	Floor Plate		547-1	Telescope Clamp Rings (2)
20	426	Floor Plate Catch		552	Telescope Clamp Ring Screws (4)
21	52	Floor Plate Catch Pin		550	Telescope Mount Ring Clamp Screws (2)
22	458	Floor Plate Catch Spring		551	Telescope Mount Ring Clamp Screw Nuts (2)
23	500	Front Sight, Low or/	37	548-1	Telescope Mount, Front
23	501	Front Sight, Medium or/	38	549-2	Telescope Mount, Rear
23	502	Front Sight, High	39	553	Telescope Mount Screw, Front
25	24	Magazine Follower	40	554	Telescope Mount Screw, Rear
26	25	Magazine Follower Spring	41	547-1	Telescope Clamp Ring
27	594	Pistol Grip Cap	42	552	Telescope Clamp Ring Screw
24	557	Pistol Grip Cap Screw	43	550	Telescope Mount Ring Clamp Screw
28	27	Rear Guard Screw Bushing	44	551	Telescope Mount Ring Clamp Screw Nut
29	587-M	Rear Sight Assembly	45	540	*Trigger
30	565	Rear Sight Elevator	48	555	Trigger Guard
31	569-1	*Receiver	49	574	Trigger Guard Screw, Front
32	412	Safety	50	575	Trigger Guard Screw, Rear
33	588-1	*Sear	46	542	Trigger Pin
34	545-1	Sear Pin	47	541	Trigger Spring
35	544	Sear Spring		994-26	Parts List
52	597	Sling Swivel, Rear			

# OTHER FAMOUS *J. C. Higgins* GUNS

See these other J. C. Higgins models at your nearest Sears Store, or send a postcard for descriptive literature on all J. C. Higgins Guns to: Sears Roebuck and Company, Dept. 139, Chicago, Illinois. Ask for J. C. Higgins Circular No. 6495. Remember, these guns give you more quality and shooting pleasure for every dollar you invest!

## Model 88 Revolver

.22 short, long and long rifle

A fine 9-shot revolver at an amazingly low price. This double- and single-action revolver of truly modern design is perfectly balanced and packed with the features and precision workmanship of handguns costing twice as much. Choice of 4" or 6" barrel. Uses .22 shorts, longs and long rifles, hi-speed or regular. Swing-out counter-bored cylinder, crisp trigger pull, single-stroke multiple ejection, adjustable rear sight, comfortable thumb-rest grips. Weight 23 oz. with 4" barrel, 25 oz. with 6" barrel.



## Model 60 Automatic Shotgun

12 Gauge

Here is the new 12-gauge automatic the whole shooting world is talking about! Fires up to five shots as fast as you can pull the trigger. Modern in every detail, yet its gas-operated mechanism is time-tested, employing a similar principle proven safe and sure in millions of the finest military weapons ever made. Barrel is permanently interlocked with receiver for perfect alignment. Perfect balance and a comfortable choice-grained walnut stock make it easy to handle, quick to respond. Full fore-end for firm, positive pointing. Available with or without Choke Control Compensator and Ventilated Rib.

Parts List 994-26

Printed in U.S.A. 6/55

J. C. Higgins Guns are sold ONLY by Sears, Roebuck and Co.  
and Simpsons-Sears Limited